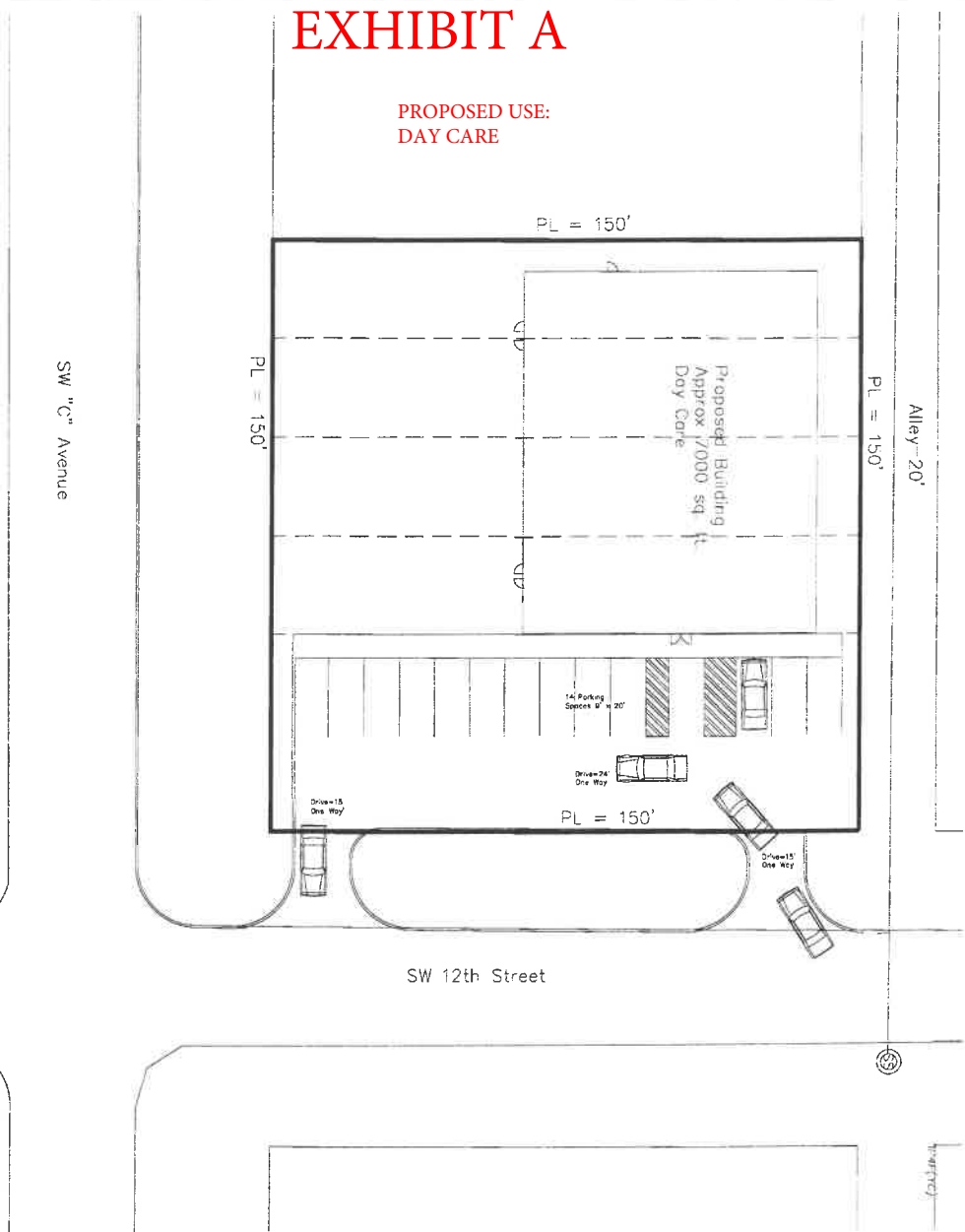

EXHIBIT A

PROPOSED USE:
DAY CARE



Property Description
Lots 20 -- 24 Block 8, Butler Addition

Owner Contact Information:
Adelola Olanrewaju
313 SW Coral Avenue
Lawton, OK, 73505
email=Kladpnde@gmail.com
Phone=580-458-0677

Blessed Day Learn and Play
1201 SW "C" Avenue
Lawton, Oklahoma



landmark engineering
(580) 357-2022
2505 N.E. Skyline Place
Lawton, Oklahoma
OK CA# 2015
SHEET TITLE: Resume Site Plan
PROJECT NO: 23gen24
DATE: 12/06/23
SHEET -- OF --

Copyright (C) 2023 by Landmark Engineering